





FF-Series	Q-Series
<p>CCD : 1/3" 960H            CHIP: Sony EFFIO "Effio" means "Enhanced Features and Fine Image Processor".</p>	<p>CCD : 1/3" 510H            CHIP : NEXT</p>
<p style="text-align: center;"><b>Body Upgrade</b></p>  <ul style="list-style-type: none"> <li>➤ New pattern square housing</li> <li>➤ Very strong wall mounting bracket</li> </ul>	
 <p>The improved mounting bracket with more thickness</p>	 <p>Very thin mounting bracket</p>
<p style="text-align: center;"><b>Image Quality</b></p>  <p>The depth and resolution of the image is high</p>	<p style="text-align: center;"><b>Image Quality</b></p>  <p>The depth and resolution of the image is medium</p>

**Color performance**

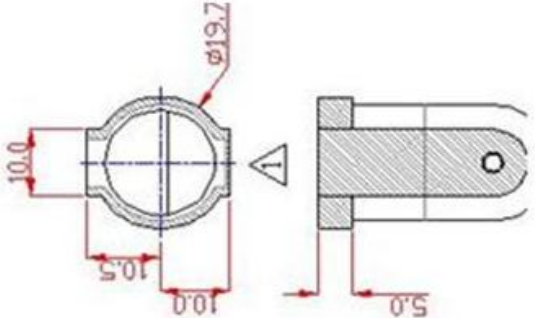
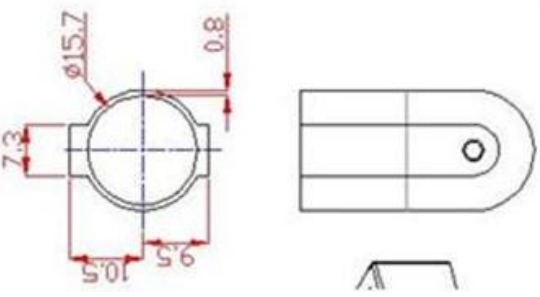

More excellent color reproduction with high resolution

**Color performance**

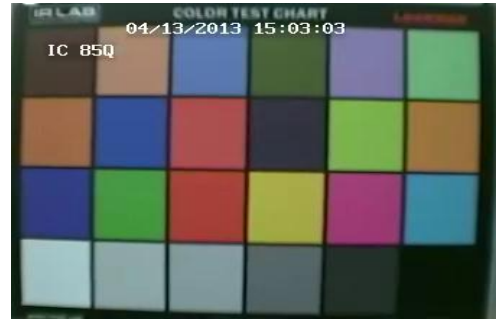

True color quality

**IR performance**



Well spread IR in night mode  
Smart IR technology

**IR performance**



Normal IR technology ,face is not recognizable

**TVL**

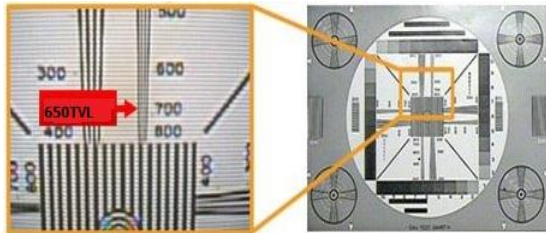

**650 TVL**

**TVL**

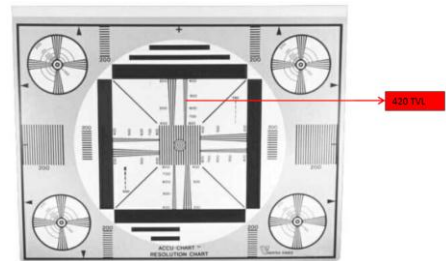

**420 TVL**